



# Addendum No.1

Date Issued: June 19, 2018

RFP Name: Culinary Art's Equipment

RFP# 2018-PUR-027

1. Is this replacing existing? If so, are we required to do removal and disposal? What are the make and models?

This is all new equipment so no on the removal/disposal of old equipment.

2. Is the equipment going to be installed on ground level?

The equipment is to be installed on the second floor.

3. Is there a dock at the location?

There is elevator access and there is a dock on the main floor.

4. Will all utilities be within 4 feet of connections?

All utilities will be within 4' of the connection needed.

5. Would you have any drawings available for RFP# 2018-PUR-027 Culinary Art's Equipment Proposal that would help in providing you the best price quote possible?

Below is a drawing of the new space.. Please note that this drawing has more equipment than what is listed on the RFP. Please only provide bids for the items listed in the RFP and not the complete list on this drawing.

KITCHEN EQUIPMENT SCHEDULE															
ITEM NO.	QUANTITY	DESCRIPTION	MANUFACTURER	MODEL	SIZE (H"xW"xD")	PLUMBING REQUIREMENTS						ELECTRICAL REQUIREMENTS			NOTES
						COLD	HOT	DIRECT WASTE	INDIRECT WASTE	VENT	GAS	LOAD (BTU/h)	VOLTAGE / PHASE	AMPS	
1	2	DOUBLE CONVECTION OVEN	VULCAN	VC4GD	70"x40"x41"	-	-	-	-	-	3/4"	100,000	120/1	-	(2) CORD & PLUG
2	4	6 BURNER RANGE	VULCAN	36S-6BN	58"x36"x34"	-	-	-	-	-	3/4"	215,000	-	-	-
3	2	FRYER	VULCAN	1GR6SM	47"x21"x30"	-	-	-	-	-	3/4"	150,000	120/1	-	18"
4	2	CHARBROILER	VULCAN	VCCB36	13"x36"x27"	-	-	-	-	-	3/4"	87,000	-	-	-
5	1	30 QUART MIXER	HOBART	HL300	50"x23"x30"	-	-	-	-	-	-	-	208/1	5.7	CORD & PLUG
6	1	DISHWASHER	HOBART	AM15VLT	80"x30"x30"	1/2"	1/2"	-	1-1/2"	-	-	-	208/3	45.4	10-1/4"
7	1	ICE MAKER	MANITOWOC	ID-0602A	72"x30"x34"	3/8"	-	-	(1) 1/2" (1) 3/4"	-	-	-	208/1	10.5	-
8	1	PROOFING CABINET	TURBOFAN	P12M	44"x29"x32"	-	-	-	-	-	-	-	120/1	15.6	CORD & PLUG
9	1	REACH-IN FREEZER	TRUE	T-46F-HC	78"x54"x29"	-	-	-	-	-	-	-	120/1	9.6	CORD & PLUG
10	1	REACH-IN COOLER	TRUE	T-72	79"x78"x29"	-	-	-	-	-	-	-	120/1	9.6	CORD & PLUG
11	1	BLAST CHILLER	EURODB	OBF054-AF	34"x34"x30"	-	-	-	1/2"	-	-	-	208/1	6.1	4"
12a	1	SOILED DISHTABLE	ADVANCE TABCO	DTS-S70-96L	34"x96"x30"	-	-	1-1/2"	-	1-1/4"	-	-	-	-	-
12b	1	PRE-RINSE BASKET	ADVANCE TABCO	DTA-100-X	19.5"x19.5"x4"	-	-	-	-	-	-	-	-	-	-
12c	1	PRE-RINSE FAUCET	ADVANCE TABCO	DTA-53-1X	-	1/2"	1/2"	-	-	-	-	-	-	-	-
13	1	GARBAGE DISPOSAL	IN-SINK-ERATOR	SS-100	-	1/2"	-	1-1/2"	-	1-1/4"	-	-	208/1	5.1	-
14	1	CLEAN DISHTABLE	ADVANCE TABCO	DTC-K70-48R	34"x47"x30"	-	-	-	-	-	-	-	-	-	-
15	4	HANDWASH SINK	ADVANCE TABCO	T-FS-30	17"x21"x17"	1/2"	1/2"	1-1/2"	-	1-1/4"	-	-	-	-	-
16	8	WORKTABLE	ADVANCE TABCO	TTS-30S	35.5"x90"x30"	-	-	-	-	-	-	-	-	-	-
17	1	3-COMP SINK	ADVANCE TABCO	FE-3-1812-18RLX	37"x90"x24"	1/2"	1/2"	-	(3) 1-1/2"	-	-	-	-	-	-
18	12	SHELVING	METRO	MQ3PE(4) MQ2180G	63"x60"x21"	-	-	-	-	-	-	-	-	-	-
19		INTEGRAL SINK PER ARCHITECTURAL PLANS													
21a	2	PREP TABLE	ADVANCE TABCO	TA-11B	12"x20"x16"	1/2"	1/2"	1-1/2"	-	1-1/4"	-	-	-	-	-
22	1	DRYING RACK	METRO	FR40K3	75"x48"x24"	-	-	-	-	-	-	-	-	-	-
23	1	WALK-IN FREEZER	AMERIKOOLER	QF081072*FBRM	77"x710"x99"	-	-	-	-	-	-	-	-	-	-
23a	1	FREEZER COND UNIT	BOHN	BHT025L6BF	17"x38"x28"	-	-	-	-	-	-	-	208/1	21	-
23b	1	FREEZER EVAP UNIT	BOHN	LET090BEVWMCCK	16"x45"x14"	-	-	-	-	-	-	-	208/1	7.8	-
24	1	WALK-IN COOLER	AMERIKOOLER	QC081072*FBRC	77"x710"x99"	-	-	-	-	-	-	-	-	-	-
24a	1	COOLER COND UNIT	BOHN	BHT010X6BFM	17"x24"x28"	-	-	-	-	-	-	-	208/1	20	-
24b	1	COOLER EVAP UNIT	BOHN	ADT090AEVWMCCK	16"x45"x14"	-	-	-	-	-	-	-	115/1	-	-
25	2	EQUIPMENT STAND	ADVANCE TABCO	EGLG-244	25"x48"x30"	-	-	-	-	-	-	-	-	-	-

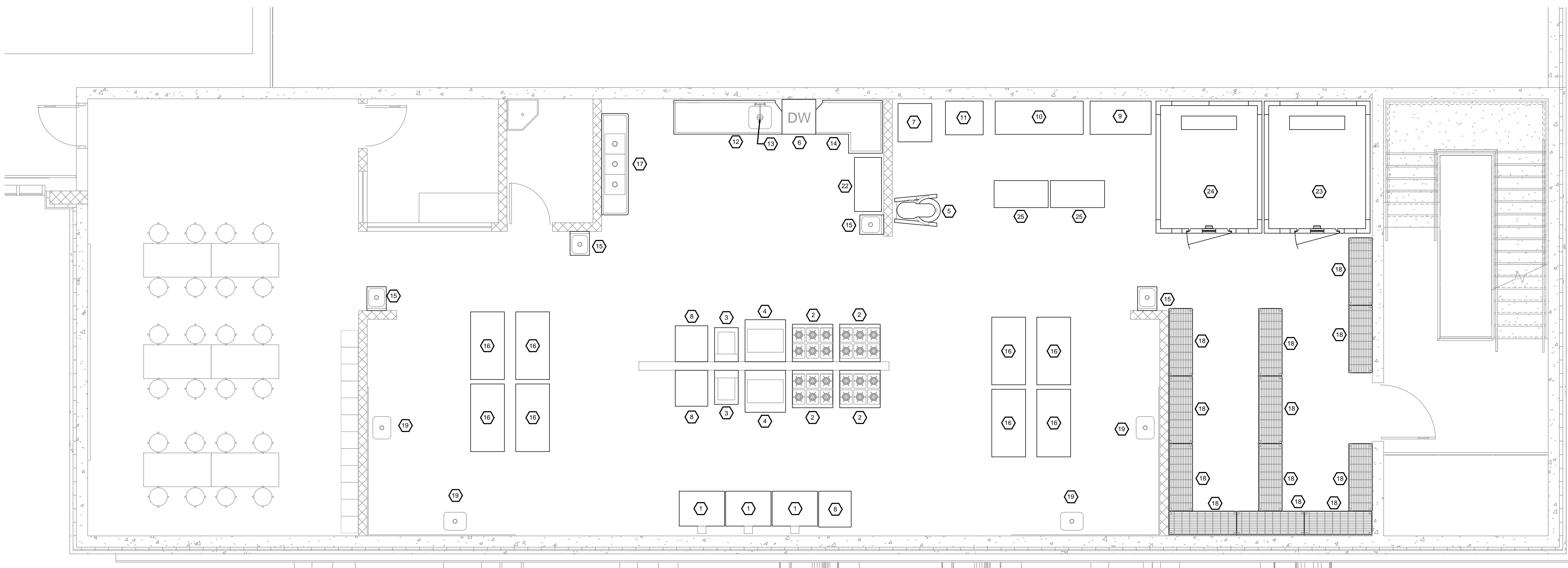

VAN HORN HIGH SCHOOL GYMNASIUM ADDITION

INDEPENDENCE, MO  
1109 S ARLINGTON AVE, INDEPENDENCE, MO 64053

REVISIONS:

#	Description	Date



JOB NO: 016-2811  
DRAWN BY: OA  
CHECKED BY: OA  
DATE: 3/14/2017

K101

OF

1828 Walnut Street Suite 922  
Kansas City, MO 64108  
T 816.412.7100

333 Parry Street Suite 205  
Castle Rock, CO 80104  
T 719.313.9729

7701 E. Kellogg Suite 550  
Wichita, KS 67207  
T 316.685.5175

HOLLISANDMILLER.COM

Hollis + Miller Architects  
Missouri State Certificate of Authority  
Architecture #0000111  
Interior # 000001133

MKEC ENGINEERING CONSULTANTS  
Civil #200 1009364  
11827 W 112th Street, Ste 200  
Overland Park, KS 66210  
913-317-9390 phone  
913-317-9385 fax

Olsson & Associates  
MEP / Food Service #001592  
7301 W 153rd Street, Ste 200  
Overland Park, KS 66213  
913-748-2519 phone  
913-748-2511 fax

Ochsner Hare & Hare  
Landscape Architect #200500285  
1801 McGee Street, Ste 101  
Kansas City, MO 64108  
816-842-8544 phone

Nabholz Construction  
Construction Manager  
1707 E. 153rd Terrace  
Olathe, KS 66061  
913-393-6500 phone  
913-393-6600 fax

hollis + miller architects  
relationships • results

BIDDING DOCUMENTS